

PLOTTED: 8/19/2020 11:14:36 AM
 NAME: P:\2018 PROJECTS\18-009.01 CHERRY CK AT KOA PROPERTY - UDFC02 FINAL DESIGN - REACH C\CAD\DRAWINGS\18-009.01_SITE_PLAN.DWG

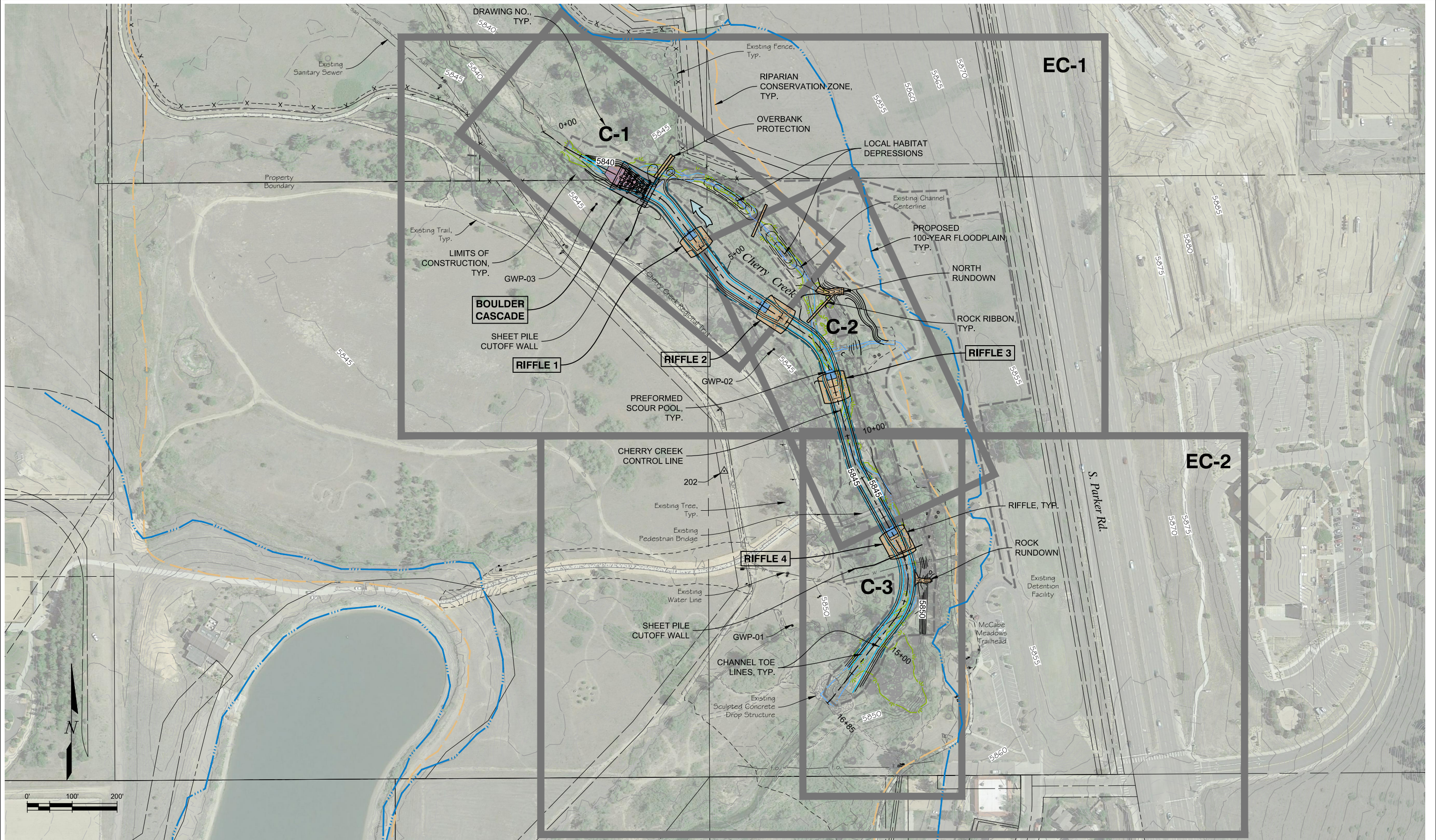

PREPARED UNDER THE SUPERVISION OF
 DESIGNED: NAY
 DRAWN: MAB
 CHECKED: CBF

CONSTRUCTION SET

PROJECT NO. 18-009.01

SHEET REVISIONS		
NO.	DATE	DESCRIPTION

MULLER ENGINEERING COMPANY
 777 S. WADSWORTH BLVD. 4-100 LAKEWOOD, COLORADO 80226

Cherry Creek Basin
 Water Quality Authority

MHFD
 MILE HIGH FLOOD DISTRICT
PARKER COLORADO

CHERRY CREEK STREAM RESTORATION IMPROVEMENTS AT KOA - REACH C		DATE 8/18/2020
GENERAL		DRAWING NO. G-3
SITE PLAN		SHEET NO. 3 of 40